

Transition Damper • 6½" Deep • Airfoil Blades • Parallel or Opposed • Round and Oval Transition • Extruded Aluminum

For use to 6 in. w.g. of static pressure

STANDARD CONSTRUCTION

FRAME: 1½" x 6½" x 1½" extruded aluminum channel frame with a .080" thick (nominal) aluminum transition piece.

BLADE: Extruded aluminum, airfoil design.

BEARINGS: Double-sealed.

LINKAGE: In jamb, out of air stream.

FINISH: Mill.

NOTES

1. Nominal deductions will be made to the opening size given.
2. Please specify blade position: Parallel or Opposed.
3. Approximate shipping weight is 7 lbs./sq.ft.

DAMPER SIZES

Min Size	Max Size
10"W x 10"H	60"W x 60"H

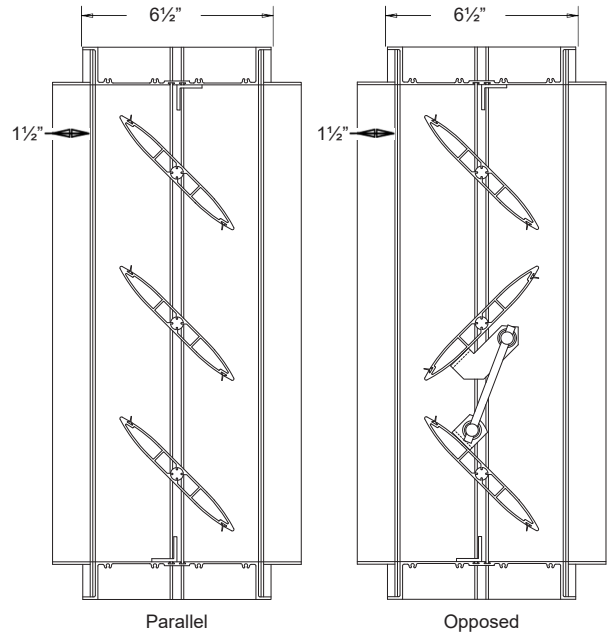

Not to scale.

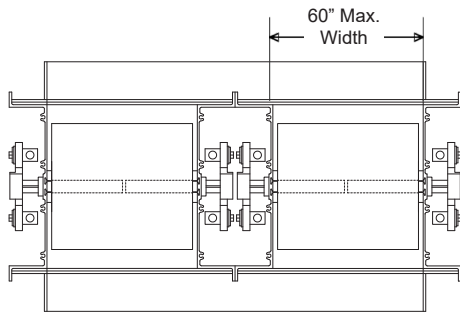

Opposed

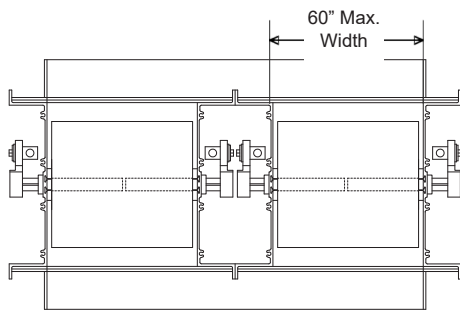

Parallel

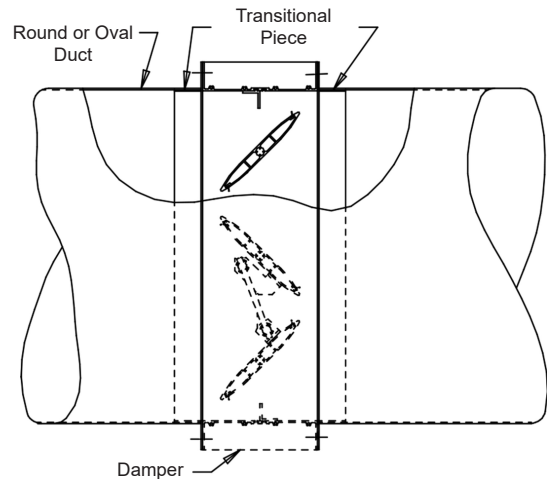

Transition Piece Detail

Item #	Qty	Width	Height	Parallel	Opposed	Round	Oval	Union Made
				Damper Size (in.)		Blade Position		
Arch. / Eng.:		EDR:		ECN:		Job:		
Contractor:		Date:		DWN:		DWG:		

In the interest of product development, Louvers & Dampers reserves the right to make changes without notice.